

PRELUDE

OPENING SONG Youth Praise Team
“Good, Good Father”

WELCOME & ANNOUNCEMENTS Elder David Onsongo

OFFERING & CHILDREN’S STORY Amy Wan

PRAISE IN GIVING World Budget (VOP)

PRAISE SET Youth Praise Team
“Shout to the Lord”
“Reckless Love”

PRAYER SONG Youth Praise Team
“As the Deer”

CONGREGATIONAL PRAYER

SERMON Pastor Eugene Kitney
“Authority—Scripture or Tradition”
Mark 7:5-13

CLOSING SONG Youth Praise Team

BENEDICTION Pastor Eugene Kitney

POSTLUDE

Elder in charge: Elder David Onsongo
David@stonehillchurch.org | (512) 970-2862

Deacon in charge: Simeon Rotich
srottich@yahoo.com | (615) 424-7751

Greeters this week: Greg & Bianca Peterson

EUGENE KITNEY *Pastor*
PastorKitney@StonehillChurch.org / (512) 708-0600

DAVID ONSONGO *Head Elder*
David@StonehillChurch.org / (512) 970-2862

ELLEN JENSEN *Treasurer*
Ellen@StonehillChurch.org

CHINYERE UYANIKER *Principal, Stonehill Christian Academy*
Cici@StonehillChurch.org / (512) 763-2776

MERI HOLM *Church Clerk*
Meri@StonehillChurch.org / (512) 537-1844

BENJAMIN ERMSHAR *Administrative Assistant*
Benjaminermshar@gmail.com / (541) 218-2331

COMMUNICATIONS TEAM
communications@stonehillchurch.org

Stonehill Church Office Hours:
Monday—Friday, 7:00am - 3:30pm

If you want to become a member or transfer membership from another church please see Meri Holm or email: Meri@StonehillChurch.org

October 12, 2019



1. Beginners..... 0 - 3 Years
2. Kindergarten..... 4 - 6 Years
3. Primary..... 7 - 9 Years
4. Juniors..... 10 - 14 Years
5. High School..... High School Years
6. Collegiate..... College Years
7. Young Professionals..... Quarterly
8. Myrna Cogan..... Quarterly
9. Ellen Jensen..... Proverbs
10. Estudio en Español..... Quarterly
11. David Onsongo..... Men's Group
12. Pr. Eugene Kitney..... Stonehill101 & Baptismal Studies

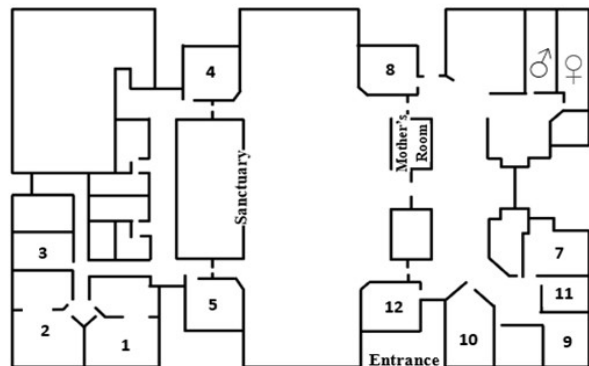

We are experimenting with the map: please excuse any errors. ☺

BREAKFAST served 9:00 to 10:00 AM

FELLOWSHIP LUNCH



All guests, friends and members are welcome to join us after the worship service for fellowship lunch.

Members, for fellowship lunch Sabbaths, we encourage you to invite guests to join you at a table. Please bring an entree, salad/vegetable and bread/dessert if you plan to stay for lunch.

If you stay for lunch please help us cleanup afterwards.

Fellowship Lunch Host

- Oct 12** Myrna Cogan SS
- Oct 19** Children's Ministries
- Oct 26** Ellen Jensen's SS
- Nov 02** Invite a Guests Home

*The lunch host is responsible for coordinating the receiving/ placement of dishes and cleanup.



Children's Ministries: Children's activity bags are available to our visitors and members during the service and can be found near the greeters table by the main entrance. Please remember to return them at the end of the service.

Youth & Family Fun Night This evening, join us at the Round Rock Multipurpose Complex, field 9, from 7:15pm-9:45pm for Soccer Night! The address is *2001 N. Kenney Fort Blvd.* Be sure to use the south parking lot!

Baby Shower Join us in welcoming the newest member of the Joline & Eric Whichelow family on November 3, 2019!

Texas Adventist Men is holding it's Annual Men's Summit on November 8-10, 2019 at the Family Center, 9425 West Sam Houston PKWY N, Houston, Texas 77064. The Theme is, "UNBROKEN: Discover, Receive and Proclaim Healing for the Broken Life." Keynote Speakers; Pastors Doug Bachelor, Wintley Phipps, Carlos Munoz and Dr Neil Nedley MD and Musicians; Neville Peter and TAM Worship Team. If you haven't Registered as yet. **SPACE IS LIMITED. REGISTER NOW @ www.texasadventistmen.org—please see bulletin insert for more details**

New Beginning SDA invites you to a night full of *God's Music.* Come and join us on October 19th from 6:30pm to 8:30pm here at Stonehill SDA Church. *Refreshments will be served at the end

Women's Ministry Retreat, "Rise and Shine" is scheduled for October 25-27, 2019, at the Embassy Suites in San Marcos, Texas. Registration fee is \$165 (after October 10 fee is \$180). To register, go to <https://www.txsda.org/reg/index.asp>. To reserve your hotel room, visit <https://embassysuites.hilton.com/en/es/groups/personalized/S/SNMESES-EWR-20191024/index.jhtml> or call 512.392.6450 (using group code EWR).

Are you needing any of these supplies? Wheel chair, portable shower chair, portable commode chair with arms, wheeled walker, standard walker, bed assist grab bar, bedside hospital table, unisex protective underwear. If so, call Elaine Steffen at (509) 860-5870



Things you need to know...

Please remember, no food or drinks in the Sabbath School classrooms. And especially, do not put food in the trash cans in any of the Sabbath School rooms. Thank you.

Ministry Opportunities

A ride to church needed. We have a student who recently moved to the area to attend UT Austin who needs a ride to church. They live on Far West Blvd. If there is anyone who can provide a ride for this student, please contact communications@stonehillchurch.org. Thank you.

Link to today's sermon online: <http://stonehillchurch.org/sermons/>. Previous sermons are also available.

Please pick up after yourself and your family. This is God's House!

Hearing Assist equipment is available: Please see one of the deacons or AV personnel.

FINANCIAL REPORT

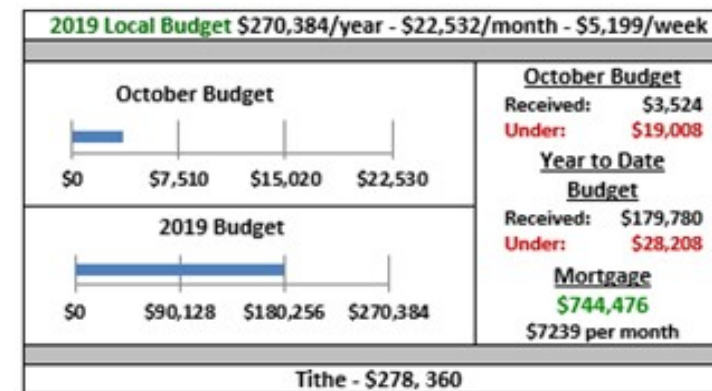

1. **Local Budget** - provides for our church ministries, building, and mortgage.
2. **Tithe** - sent to Texas Conference for administrative support in Texas and worldwide church.
3. **Mark specific donations** on your offering envelope. Please clearly print address and first & last name on envelope. All unmarked and loose offering is used to support our Local Budget.
4. **Give online** from our website, stonehillchurch.org.
5. **Save labels** (Loma Linda, Worthington). Kellogg Corporation supports NAD mission projects for collected labels from canned items.